

**S I M B O L O G I A**

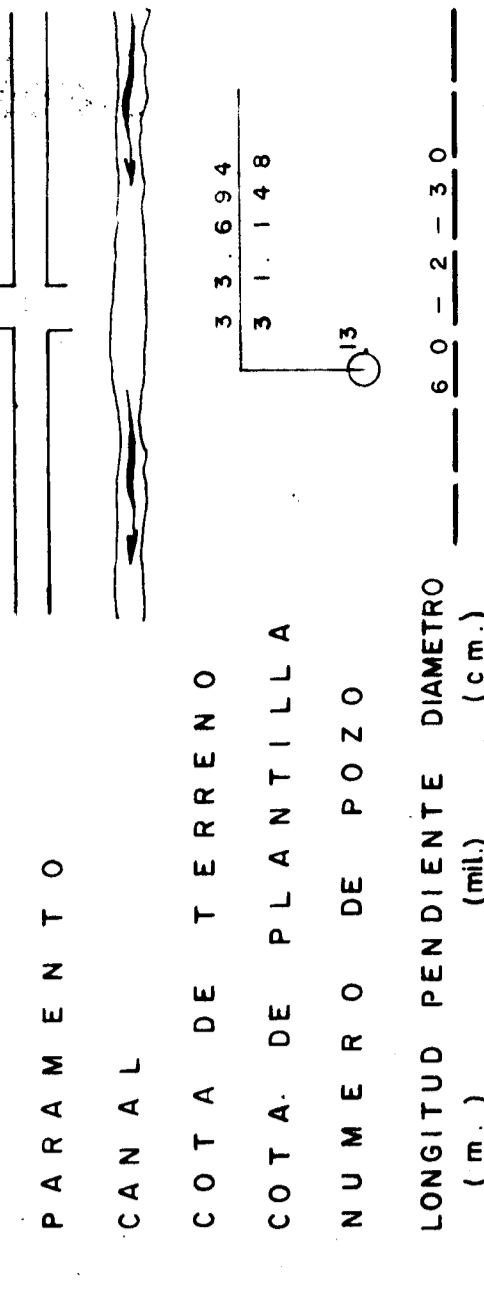

**NOTAS :**

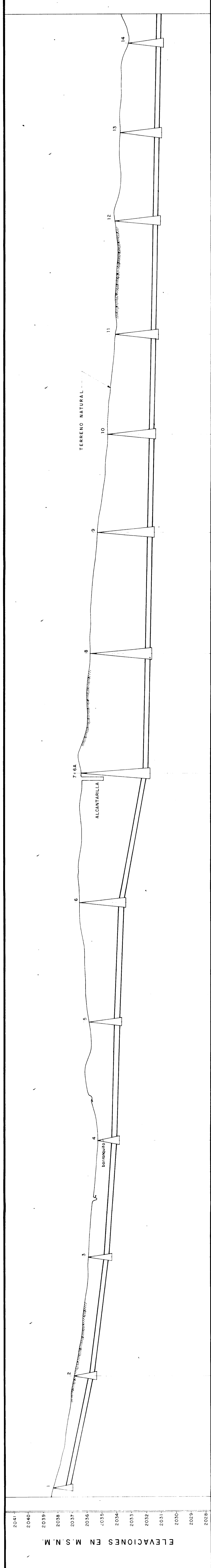
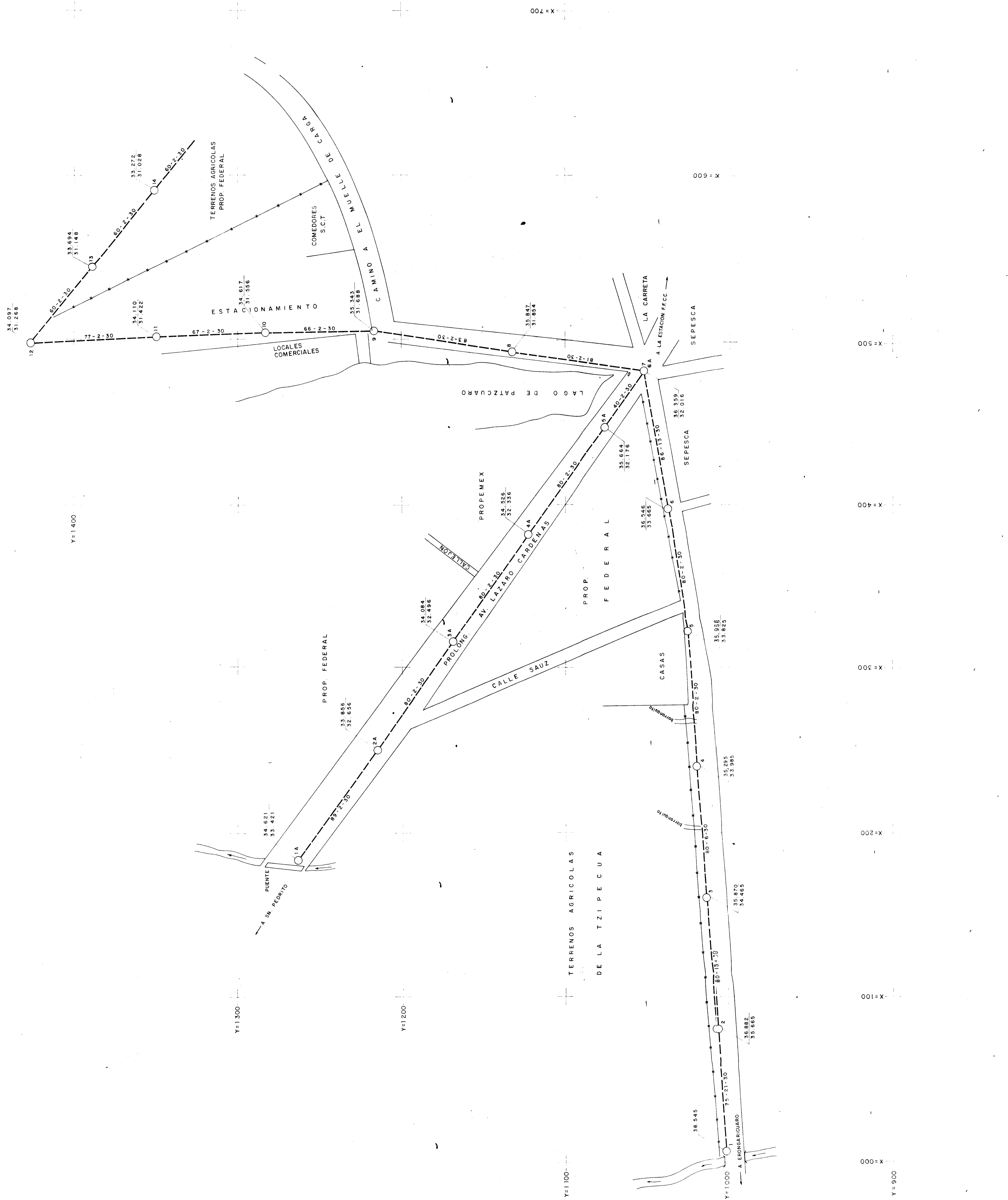

| COTAS DE PLANTILLA | COTA DE TERRENO | COTAS DE PLANTILLA | COTA DE TERRENO |
|--------------------|-----------------|--------------------|-----------------|
| 35.850             | 36.822          | 0+800.00           | 35.850          |
| 35.850             | 36.822          | 0+850.00           | 35.850          |
| 35.850             | 36.822          | 0+900.00           | 35.850          |
| 35.850             | 36.822          | 0+950.00           | 35.850          |
| 35.850             | 36.822          | 1+000.00           | 35.850          |
| 35.850             | 36.822          | 1+050.00           | 35.850          |
| 35.850             | 36.822          | 1+100.00           | 35.850          |
| 35.850             | 36.822          | 1+150.00           | 35.850          |
| 35.850             | 36.822          | 1+200.00           | 35.850          |
| 35.850             | 36.822          | 1+250.00           | 35.850          |
| 35.850             | 36.822          | 1+300.00           | 35.850          |
| 35.850             | 36.822          | 1+350.00           | 35.850          |
| 35.850             | 36.822          | 1+400.00           | 35.850          |
| 35.850             | 36.822          | 1+450.00           | 35.850          |
| 35.850             | 36.822          | 1+500.00           | 35.850          |
| 35.850             | 36.822          | 1+550.00           | 35.850          |
| 35.850             | 36.822          | 1+600.00           | 35.850          |
| 35.850             | 36.822          | 1+650.00           | 35.850          |
| 35.850             | 36.822          | 1+700.00           | 35.850          |
| 35.850             | 36.822          | 1+750.00           | 35.850          |
| 35.850             | 36.822          | 1+800.00           | 35.850          |
| 35.850             | 36.822          | 1+850.00           | 35.850          |
| 35.850             | 36.822          | 1+900.00           | 35.850          |
| 35.850             | 36.822          | 1+950.00           | 35.850          |
| 35.850             | 36.822          | 2+000.00           | 35.850          |
| 35.850             | 36.822          | 2+050.00           | 35.850          |
| 35.850             | 36.822          | 2+100.00           | 35.850          |
| 35.850             | 36.822          | 2+150.00           | 35.850          |
| 35.850             | 36.822          | 2+200.00           | 35.850          |
| 35.850             | 36.822          | 2+250.00           | 35.850          |
| 35.850             | 36.822          | 2+300.00           | 35.850          |
| 35.850             | 36.822          | 2+350.00           | 35.850          |
| 35.850             | 36.822          | 2+400.00           | 35.850          |
| 35.850             | 36.822          | 2+450.00           | 35.850          |
| 35.850             | 36.822          | 2+500.00           | 35.850          |
| 35.850             | 36.822          | 2+550.00           | 35.850          |
| 35.850             | 36.822          | 2+600.00           | 35.850          |
| 35.850             | 36.822          | 2+650.00           | 35.850          |
| 35.850             | 36.822          | 2+700.00           | 35.850          |
| 35.850             | 36.822          | 2+750.00           | 35.850          |
| 35.850             | 36.822          | 2+800.00           | 35.850          |
| 35.850             | 36.822          | 2+850.00           | 35.850          |
| 35.850             | 36.822          | 2+900.00           | 35.850          |
| 35.850             | 36.822          | 2+950.00           | 35.850          |
| 35.850             | 36.822          | 3+000.00           | 35.850          |

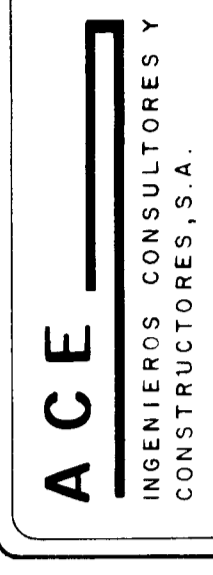
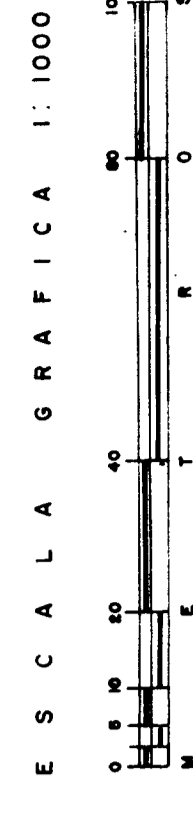

**P E R F I L G E N E R A L**

ESC. VERTICAL 1:100  
ESC. HORIZONTAL 1:1000

**SECRETARIA DE DESARROLLO URBANO Y ECOLOGIA**  
**SUBSECRETARIA DE ECOLOGIA**  
 DIRECCION GENERAL DE PREVENCIÓN Y CONTROL DE LA CONTAMINACIÓN AMBIENTAL  
**PC-5**  
 PROYECTO DE DESARROLLO PARA LAS ZONAS RURALES EN PATZÚN, MICHISTÁN, CANTÓN, YUCATEC  
**COLECTOR EMBARCADERO DEL POZO DE VISITALIA Y RAMAL DEL IA AL 6A**  
 SECRETARÍA DE DESARROLLO URBANO Y ECOLOGÍA  
 SUBSECRETARÍA DE ECOLOGÍA  
 DIRECCIÓN GENERAL DE PREVENCIÓN Y CONTROL DE LA CONTAMINACIÓN AMBIENTAL  
 PROYECTO DE DESARROLLO PARA LAS ZONAS RURALES EN PATZÚN, MICHISTÁN, CANTÓN, YUCATEC  
 COLECTOR EMBARCADERO DEL POZO DE VISITALIA Y RAMAL DEL IA AL 6A  
 INGENIEROS CONSULTORES Y CONSTRUCTORES S.A.S.